



WATERBUSTER® PORTABLE POWER PUMP™

4140

INSTALLATION INSTRUCTIONS

11/2012

69243 Rev. 1

SAVE THESE INSTRUCTIONS

FEATURES

The Attwood WaterBuster® Portable Power Pump™ is a compact, submersible pump. It is extremely handy around the dock, house or farm. And, it's ideal for removing water from dinghies, inflatables, paddle boats and kayaks.

The WaterBuster® will lift water to a maximum height of 40 in (1 meter) and pumps in excess of 200 gallons (900 liters) per hour with fresh batteries.

The pump is made of high-impact plastic. It is completely portable and ready for use when 3 "D" size alkaline batteries are installed (batteries not included). It comes complete with a 40 in (106 cm) hose and a male hose fitting for attachment to your garden hose.

OPERATING INSTRUCTIONS

IMPORTANT: To avoid airclock (flow stoppage), submerge pump in water before turning on. If pump must be turned on before submerged, it may take 10-30 seconds for the water to begin to flow (allowing pump to clear airclock).

- To install batteries, remove top cover of pump by turning the handle counterclockwise. If necessary, break o-ring seal by pressing on left side of handle then right side (see Figure 1). Unplug the wire leads and remove battery retainer (see Figure 2 detail). Insert three (3) alkaline "D" size batteries in position as indicated on the battery retainer. Replace battery retainer, re-attach wire leads and lock cover in place (wire leads are different sizes to prevent improper wiring). The pump is completely portable and ready for use when batteries are installed.
- Place pump into water at the deepest point possible, minimum 3/4 inch. Make sure the pump is located in area free of debris to avoid clogging. With bottom filter plate attached, pump will sink. If you want the pump to float, remove bottom plate by removing the four screws. The pump will then naturally float in an upright position.

NOTE: Floating the pump is desired when you wish to pump out an area that has debris at the bottom. See step 1 under Servicing Instructions. Some possible uses are: emptying aquarium without picking up aquarium gravel; filling livewell with the same water as being fished; pumping out pools or reservoirs of greater depth than the pump hose length and pumping out basement sump reservoir to avoid sludge at the bottom.

IMPORTANT: Keep pump tethered to prevent it from floating out of reach.

- To start pump, push switch located directly below cover. Hold pump in position until the water begins flowing out of the hose. Check frequently to be sure water is flowing properly and pump is free from debris.
- If water is flowing slowly, check hose for kinks or debris. Turn pump off if it is necessary to remove debris. To remove debris, simply remove pump from water and turn it upside down, looking for obvious obstructions. If further inspection is necessary, consult Servicing Instructions.

NOTE: After use, always flush the pump thoroughly with fresh clean water, especially after pumping sea water or chlorinated water.

BATTERY & PUMP TIPS

- Install fresh, name-brand alkaline batteries in this pump. While they may cost a bit more, tests have shown that they will run this pump continuously for up to 5 hours, while standard "D" batteries will only last a 1/2 hour or less.
- Do not mix old and new batteries. Do not mix alkaline, standard (carbon-zinc), or rechargeable (ni-cad, ni-mh, etc) batteries.
- Remove batteries from the pump when they are discharged or if the pump will be

stored for an extended period. Discharged batteries occasionally leak, which will destroy the electrical circuit of the pump.

- Dispose of used batteries in a safe place. Follow battery manufacturer's recommendations. Do not burn them because they can explode. Do not throw in lakes, streams or rivers.
- Keep the inside of the pump dry at all times. If it does get wet inside, dry it immediately. A hair dryer held 12 in (30.48cm) away works well. Make certain the cover is tight before immersing the pump. Keep the O-ring lubricated with petroleum jelly.

SERVICING INSTRUCTIONS FOR CLEANING OUT DEBRIS AND HOSE PLACEMENT

1. Turn the WaterBuster® Portable Power Pump™ upside down and remove the filter screen by removing the four screws with a Phillips screwdriver. Remove all debris (Figure 3).

2. Remove the impeller chamber cap by removing all five screws. Remove all possible debris.

NOTE: The correct rotation of the impeller is counterclockwise, when viewing from the bottom of the pump. If the impeller rotates clockwise, or not at all, check the batteries for correct insertion.

3. When replacing the hose, remove impeller chamber cap (see Step 2 above). Remove existing hose and thread replacement hose clockwise through the hose opening in pump housing.

4. Place the end of the hose to the end of the ribbed section of the impeller chamber (see Figure 3). Make sure there are no kinks in the hose.

5. To keep the hose in place, brace the hose with your thumb just outside the impeller chamber. Replace the impeller chamber cover and secure it by bracing your thumb on top of it. Replace and tighten screws. DO NOT OVER TIGHTEN.

6. Replace the filter screen by lining up the screw holes with the screw posts and the notch in the screen with the V-shaped protrusion in the pump housing. Replace and tighten screws. DO NOT OVERTIGHTEN.

⚠ WARNING:

This product is intended for pumping water only. Do not use to pump gasoline, diesel fuels or flammable harsh chemicals of any kind. Fluids other than water may destroy this product and/or create a fire hazard.

This portable pump is not intended for permanent installation in a bilge or sump area. It should not be used in situations where risk of personal injury or property damage could result from pump or battery failure. Do not use any power source other than three (3) "D" size alkaline batteries to power the pump. Do not attempt to recharge batteries while installed in this product.

NOTE: To conserve batteries, you may use a siphon action (see Figure 4). The discharge end of the hose must be below the water level. To completely drain water, it must be below the lowest water level. With the pump and hose as shown, turn the pump on until water flows, then turn the pump off. Water will continue to flow, but at a slower rate. This method can also increase the pumping rate with the pump turned on.

Technical Service Number: 616-897-2301

©2013 Attwood Corporation

1016 N. Monroe Street, Lowell, MI 49331-0260

www.attwoodmarine.com

FIGURE 1 / FIGURA 1

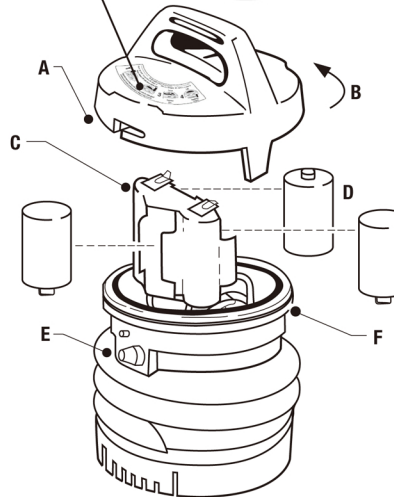
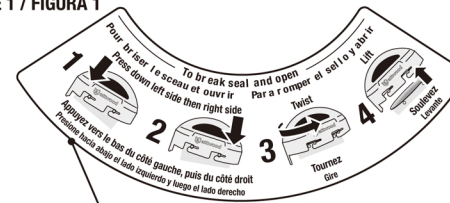

Figure 1

- A. Top cover
- B. To open
- C. Battery retainer
- D. 3 "D" batteries
- E. Hose
- F. O-Ring

Figure 1

- A. Couvercle supérieur
- B. Pour ouvrir
- C. Dispositif de retenue des piles
- D. 3 piles « D »
- E. Couvercle inférieure
- F. Joint torique

Figure 1

- A. Tapa superior
- B. Para abrir
- C. Sujetador de pilas
- D. 3 pilas tamaño "D"
- E. Tapa inferiora
- F. Junta tórica

FIGURE 2 / FIGURA 2

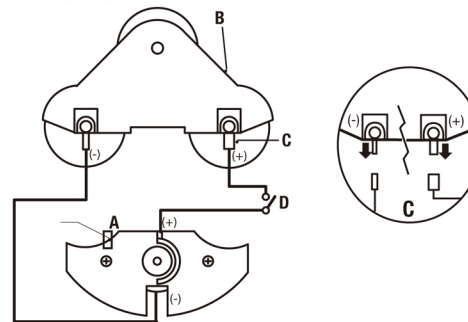

Figure 2 Detail

- A. Motor Unit
- B. Battery Retainer
- C. Wire Lead
- D. Switch

Figure 2 Detail

- A. Unidad del motor
- B. Dispositif de retenue des piles
- C. Fil conducteur
- D. Interrupteur

Figure 2 Detail

- A. Unidad del motor
- B. Sujetador de pilas
- C. Cable de alimentacion
- D. Interruptor

FIGURE 3 / FIGURA 3

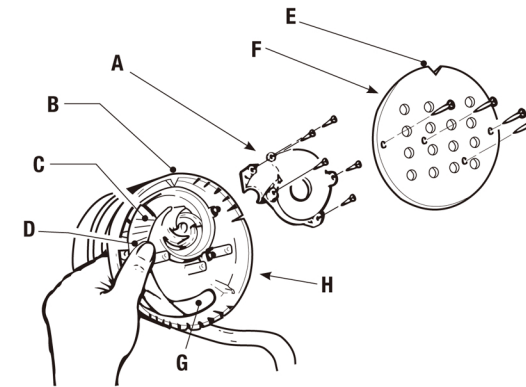

Figure 3

- A. Impeller chamber cap
- B. V-Shape protrusion
- C. Retention Ribs
- D. Hose
- E. Notch
- F. Screen plate
- G. Hose opening
- H. Pump housing

Figure 3

- A. Capuchon de la chambre du rotor
- B. Saillie en forme de V
- C. Nervures de rétention
- D. Tuyau
- E. Encoche
- F. Plaque perforée
- G. Ouverture du tuyau
- H. Boîtier de pompe

Figura 3

- A. Tapa de la cámara del impulsor
- B. Protuberancia en V
- C. Aletas de retención
- D. Manguera
- E. Muesca
- F. Placa de malla
- G. Abertura de la manguera
- H. Caja de la bomba

FIGURE 4 / FIGURA 4

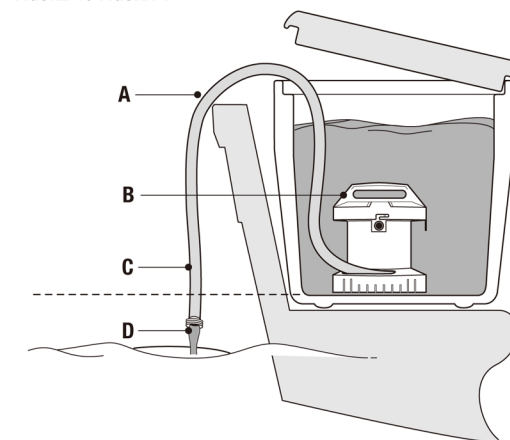

Figure 4

- A. Hose
- B. Pump
- C. Siphon action
- D. Keep end of hose at lowest water level

Figure 4

- A. Tuyau
- B. Pompe
- C. Action siphonique
- D. Gardez l'extrémité du tuyau en dessous du niveau d'eau le plus bas

Figura 4

- A. Manguera
- B. Bomba
- C. Acción sifón
- D. Mantenga el extremo de la manguera por debajo del nivel más bajo de agua